

OPTIChlor™-T3 Replacement Parts for Chloropac® Hypochlorite Generators



Optimum Anode Technologies is recognized as a reliable quality supplier of dimensionally stable anodes with superior lead times and is a business affiliate of Titan Metal Fabricators. Optimum Anode Technologies combines the excellent reputation and manufacturing know-how of Titan Metal Fabricators, a leading supplier of titanium and other exotic metal fabrication, with the industry experience of Optimum Anode Technologies' management in the manufacturing of dimensionally stable anode coatings. Our industry experts have more than 25 years of experience in anode technology, manufacturing and market expertise in supplying cost effective products that meet or exceed our customers' dimensionally stable anode needs.

Optimize the performance of your Chloropac® CTE (Concentric Tubular Electrode) electrochlorination system with Optimum Anode Technologies' *OPTIChlor*™-T3 custom manufactured cell replacement parts to maximize reliability, on-stream performance, and reduce overall life cycle cost.

Optimum Anode Technologies' *OPTIChlor*™-T3 cell components are manufactured to exact dimensional specifications and tolerances for easy replacement, interchangeability, and continuous trouble-free operation. Each component must pass our stringent criteria for quality assurance and testing prior to shipment to the customer's site. Replacement components come with a one year conditional guarantee from date of installation or 18 months from date of shipment while the anode coating is typically guaranteed for 5 years.

The *OPTIChlor*™-T3 cell anodes are coated with Optimum Anode Technologies, Inc. proven ChlorOxide™-SE or PurePlat™ coating to achieve maximum electrolytic performance and coating life with low power consumption. While the ChlorOxide™SE mixed metal oxide coating is suitable for most warm water installations, PurePlat™ provides superior performance in cold water applications (<10 C) or in the presence of high levels of organic contaminants or trace metals.

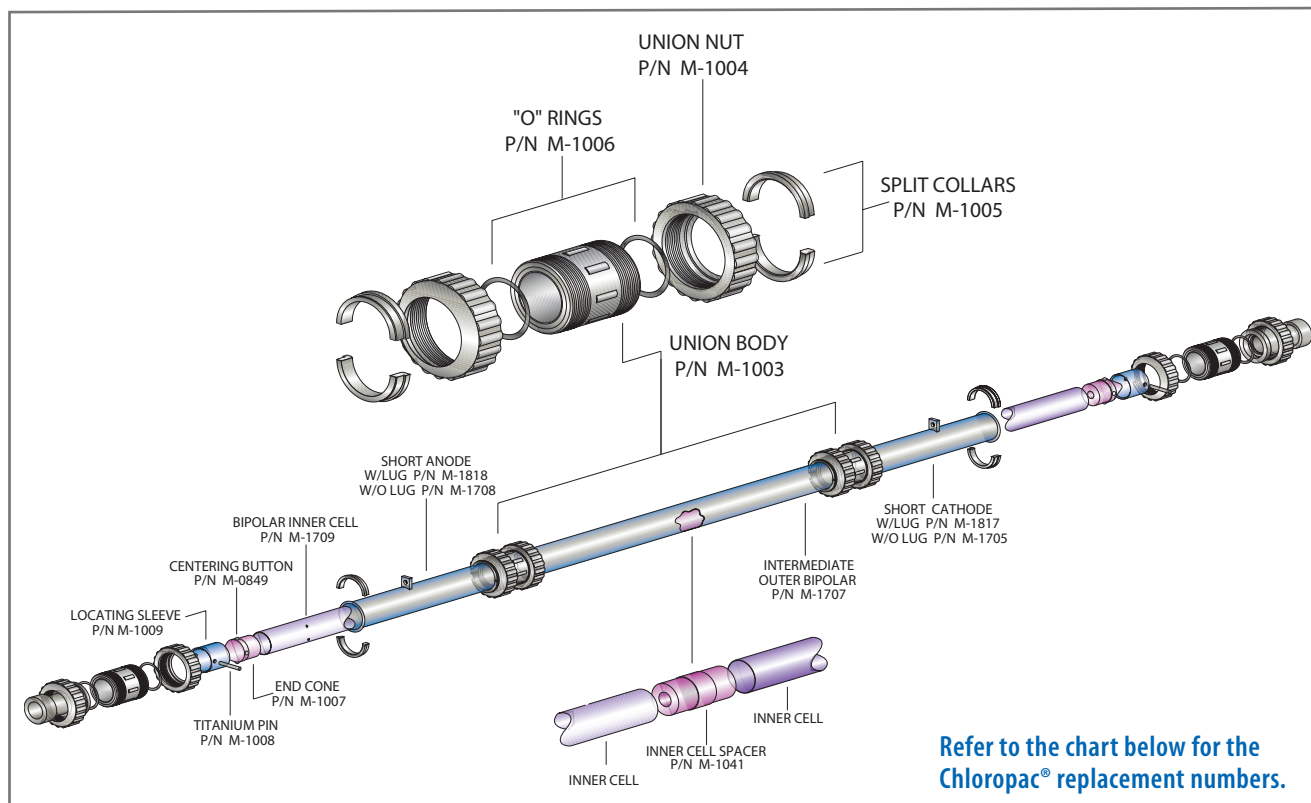

Description of Part	Chloropac® Part No.	OAT Equivalent Part No.
Centering Button	5/0849	M-0849
Union Body	5/1003	M-1003
Union Nut	5/1004	M-1004
Split Collars	5/1005	M-1005
O' Rings	5/1006	M-1006
End Cone	5/1007	M-1007
Titanium Pin	5/1008	M-1008
Locating Sleeve	5/1009	M-1009
Inner Cell Spacer	5/1041	M-1041
Short Cathode (w/o lug)	5/1705	M-1705
Intermediate Outer Bipolar	5/1707	M-1707
Short Anode (w/o lug)	5/1708	M-1708
Bipolar Inner Cell	5/1709	M-1709
Short Cathode (with lug)	5/1817	M-1817
Short Anode (with lug)	5/1818	M-1818

The commitment of Optimum Anode Technologies' management is to provide our customers a quality product in a timely manner that meets or exceeds their technical and operational needs. We continually apply our unique fact finding and discovery consultative selling process to provide the most cost-effective solution for our customers.



Optimum Anode Technologies, Inc.

352 Balboa Circle, Camarillo, CA 93012 • Phone: 805-437-7435 • Fax: 805-484-5880

www.optimumanodes.com

All information and statements contained herein are believed to be accurate, but Optimum Anode Technologies makes no warranty with respect thereto, including but not limited to any results to be obtained or the infringement of any proprietary right. Use of application of such information or statements is at user's sole discretion, without any liability on the part of Optimum Anode Technologies. Nothing herein shall be construed as a license of or recommendation for use which infringes any proprietary right. All sales are subject to Optimum Anode Technologies' Standard Terms of Sale.

Chloropac® is a registered trademark of Siemens Water Technologies

© Copyright 2012 Optimum Anode Technologies, Inc.